

2 BED UNIT TO REAR - CIRCA 61sqm/656sqft approx.

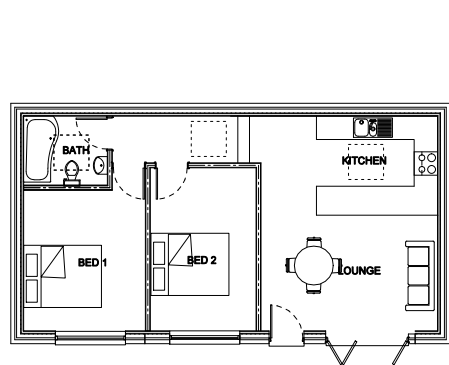

Ground Floor Plan

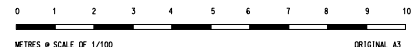
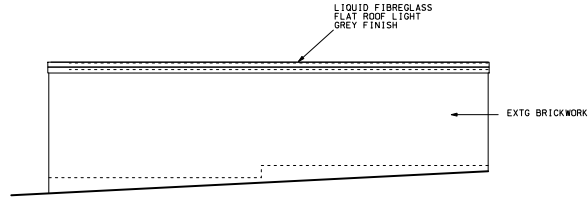

A 9/12/19 Amended scheme for planning re-submission

Prestige Projects Management Ltd		PROJECT: Re-development of Building yard to 1x2 bed flat, 1x1 bed flat, 1 No. 2 bed house and extg house retained DRAWING: 160 C proposed plans and elevations	DATE	SCALE 1:100	
3, Marlowes Court, 67 Marlowes Hemel Hempstead Herts. HP1 1LE Tel/Fax 01442 213888	CLIENT: Claimark ADDRESS: 160 Cotterells Hemel Hempstead Herts. HP1 1JW		12/08/19	JOB No.: 834	Drawing No.: PL/003