

TOPOGRAPHICAL KEY

SURVEY STATION		5
BANKING		TOP BOTTOM
HEDGE SPREADS		
WOODLAND CANOPY		
MARSH / WATERLOGGED		
TREES		SPREAD & GIRTH SHOWN TO SCALE
GATE		
KERB CHANNEL		
ROAD UNKERBED		
FOOTPATH		
CHANGE IN SURFACE		
FENCE		
WALL		
OVERHEAD ELECTRIC		N
OVERHEAD TELECOM		
FOUL SEWER		
SURFACE SEWER		
P-TRAP		
BUILDING AT GROUND FLOOR LEVEL		
BUILDING ABOVE GROUND FLOOR LEVEL		
GLASSHOUSE		
CONTOUR		25.50
SPOT LEVEL		+ 127.13
BORE HOLE		BH
TRIAL HOLE		TH
GENERAL ABBREVIATIONS		
AIR CONDITIONING UNIT		
AIR VALVE		
BACK DROP		
BRICK		
BOLLARD		
BUS STOP		
BT INSPECTION COVER		
CABLE TV COVER		
CONTROL BOX		
COVER LEVEL		
CATCH PIT		
DROP KERB		
ELECTRICITY CONTROL BOX		
ELECTRICITY POLE		
EARTH ROD		
FIRE HYDRANT		
FLOOR LEVEL		
FOOTPATH		
FOUL WATER SEWER		
GAS VALVE		
GATE POST		
GULLY		
INSPECTION COVER		
INVERT LEVEL		
KERB OUTLET		
LAMP POST		
MANHOLE		
MARKER POST		
METER		
ORDNANCE SURVEY BENCH MARK		
POST BOX		
P-TRAP		
ROAD SIGN		
RAIN WATER PIPE		
RETAINING WALL		
STOP COCK		
STREET NAME PLATE		
STAY CABLES		
SURFACE WATER SEWER		
STOP VALVE		
SOIL VENT PIPE		
TACTILE PAVING		
TELEPHONE CALL BOX		
TRAFFIC LIGHT		
TELECOM POLE		
UNABLE TO LOCATE		
UNABLE TO RAISE		
UNABLE TO SURVEY		
VENT PIPE		
WATER LEVEL		
WATER METER		
WASH OUT		
FENCE ABBREVIATIONS		
BARBED WIRE FENCE		
CLOSE BOARDED FENCE		
CONCRETE PANEL FENCE		
CORRUGATED IRON FENCE		
CHAIN LINK FENCE		
CHESTNUT PALING		
IRON RAILINGS		
POST AND RAIL FENCE		
POST AND WIRE FENCE		
WIRE MESH FENCE		
ABBREVIATIONS		
ACU		
AV		
BD		
BK		
BO		
BS		
BT		
CATV		
CB		
CL		
C/PIT		
DK		
EP		
ER		
FH		
FL		
FP		
FWS		
GV		
GP		
GY		
IC		
IL		
KO		
LP		
MH		
MK		
MT		
OSBM		
P.BOX		
PT		
RS		
RWP		
RW		
SC		
SNP		
ST		
SWS		
SV		
SVP		
TAC		
TCB		
TL		
TP		
UTL		
UTR		
UTS		
VP		
WL		
WM		
WO		
B/W		
C/B		
CPL		
C/I		
C/L		
CNP		
I/R		
P/R		
P/W		
W/M		

207550 N

207525 N

207500 N

505625 E

505625 E

505650 E

505650 E

505675 E

505675 E

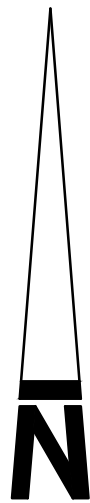

207550 N

207525 N

207500 N

ALEXANDRA ROAD

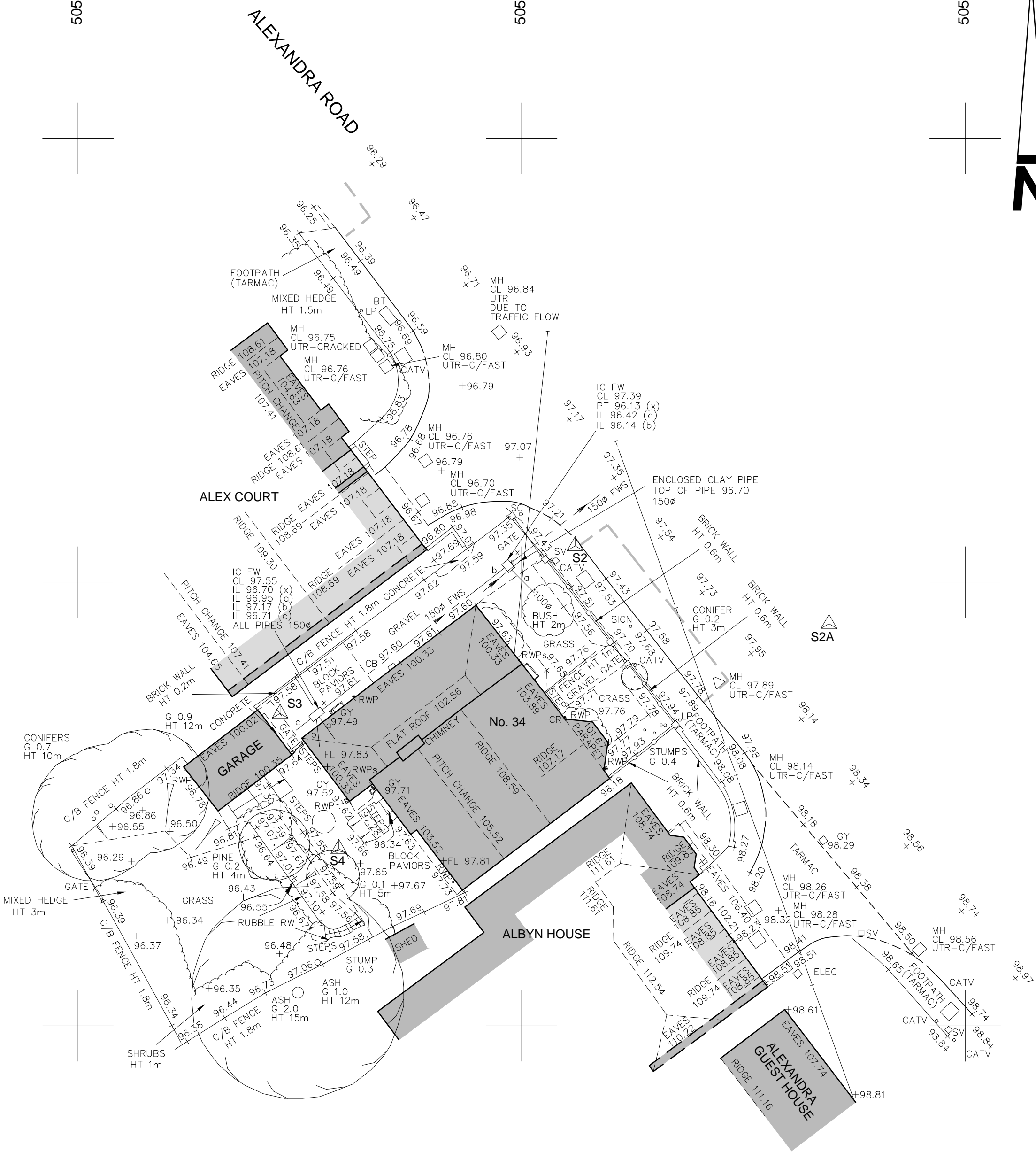

Notes :

1. GRID AND LEVELS BASED ON ORDNANCE DATUM, DERIVED FROM THE NATIONAL GPS NETWORK. LSF HAS BEEN REMOVED FROM ALL CALCULATIONS.
2. DRAINAGE INFORMATION HAS BEEN DETERMINED WITHOUT MAN ENTRY INTO CHAMBERS AND WHILST EVERY EFFORT HAS BEEN MADE TO CORRECTLY IDENTIFY THIS INFORMATION, IT SHOULD ALWAYS BE CHECKED IN AREAS THAT ARE CRITICAL TO THE FUTURE PROPOSAL.
3. ALL SEWERS ARE PRESUMED TO BE STRAIGHT BETWEEN CHAMBERS, WITH ROUTES /CONNECTIVITY OBTAINED USING ACOUSTIC METHODS ONLY. THESE ARE TO BE CONSIDERED ASSUMED AND SHOULD BE INVESTIGATED FURTHER IN CRITICAL AREAS.
4. TREE AND HEDGE SPECIES HAVE BEEN IDENTIFIED AS ACCURATELY AS POSSIBLE BUT SHOULD BE CROSS CHECKED IN CRITICAL AREAS.
5. ARROWS ON STEPS DENOTE DIRECTION UPWARDS.

Coordinate Table

Station	Description	Easting	Northing	Level
S1	ROAD NAIL	505694.240	207494.894	99.689
S2	ROAD NAIL	505653.019	207527.041	97.335
S2A	HILTI NAIL	505667.321	207522.658	98.008
S3	ROAD NAIL	505636.389	207517.601	97.468
S4	ROAD NAIL	505639.698	207509.981	97.644

1	Levels ammended around kerb radius near driveway	NC	RPE	02/08/16
Revision	Description	Surv. by	Appr. by	Date

0m

2

4

6

8

10

12

14

16

18

mksurveys

Tel 01908 565561
Tel 01865 594979
Tel 0116 2849127
Tel 01354 404203
Tel 01403 243162

Milton Keynes
Oxford
East Midlands
West Midlands
Horsham

enquiries@mksurveys.co.uk
oxford@mksurveys.co.uk
eastmidlands@mksurveys.co.uk
westmidlands@mksurveys.co.uk
horsham@mksurveys.co.uk

www.mksurveys.com

www.surveys4bim.co.uk

Mr Bill Cleeve

34 Alexandra Road
Hemel Hempstead
Hertfordshire

Topographical Survey

Scale 1:200	Sheet Size: A2	Sheet Number: 1	Date: July 2015
Project Number: 21268	Rev: 1	Surveyed By: SPB	Approved By: RPE