

Site location

1:1250

Accommodation Schedule

- Plot 1: 1 bed 54.06m²
- Plot 2: 2 bed 64.95m²
- Plot 3: 2 bed 77.2m² (duplex)
- Plot 4: 2 bed 54.6m²
- Plot 5: 2 bed 62.37m²
- Plot 6: 2 bed 54.60m²
- Plot 7: 2 bed 58.55m²
- Plot 8: 2 bed 58.00m²

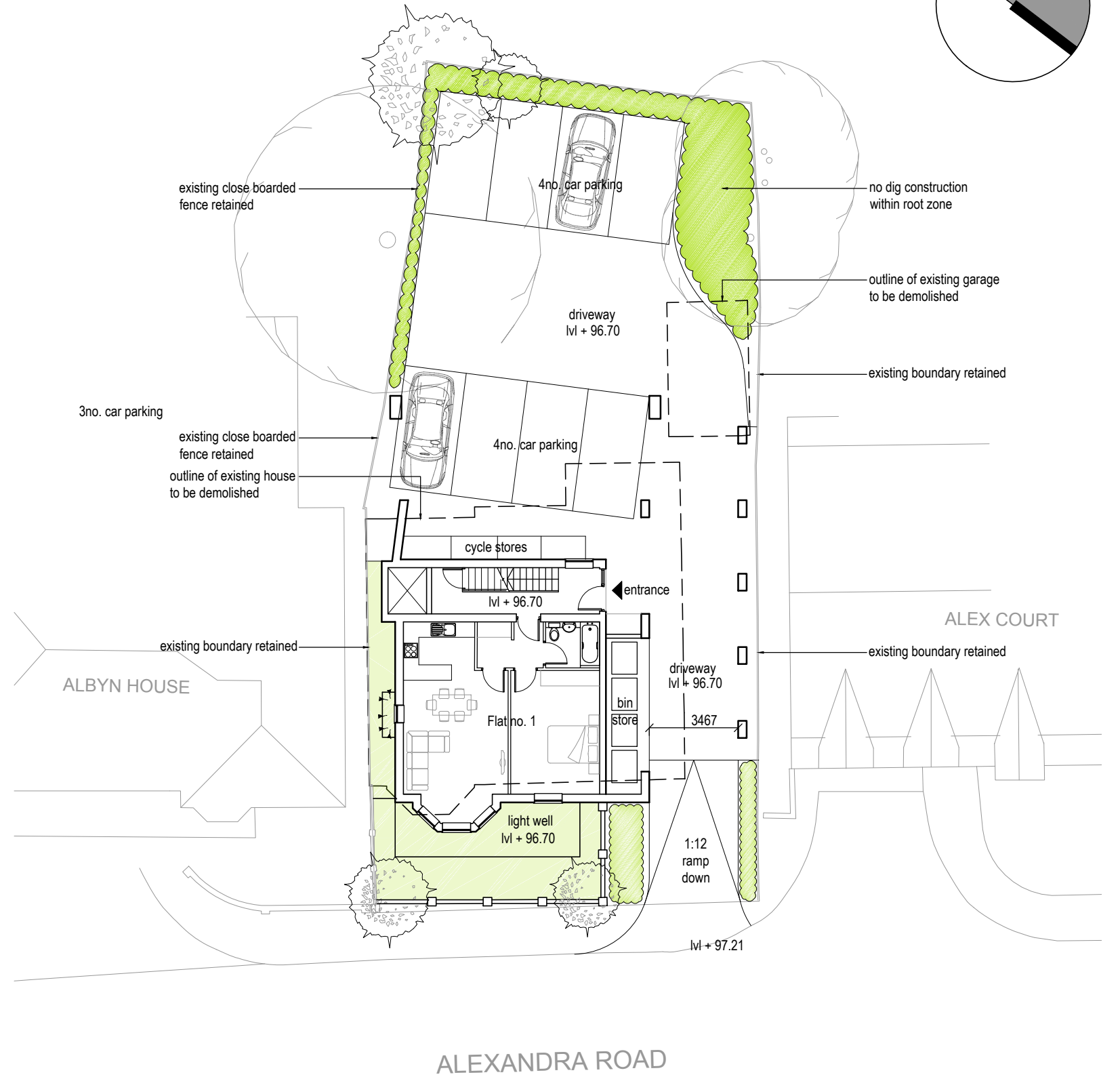
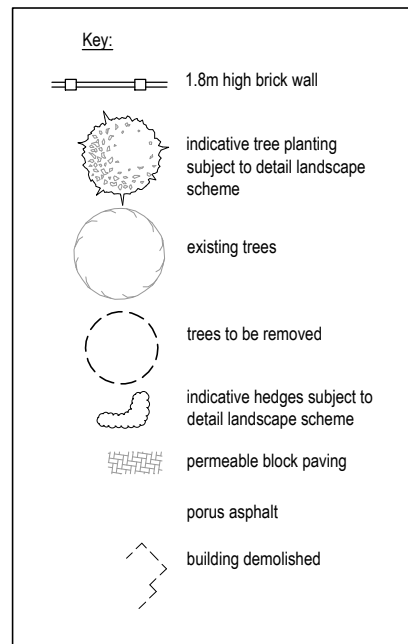

Block Plan

showing ground floor plan

1:200

100
90
80
70
60
50
40
30
20
10

Rev	Date	Comments

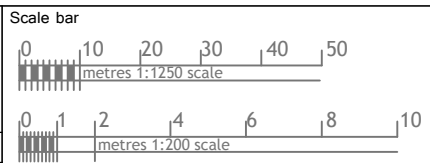

nettassets
Architectural Design & Development Consultants

Title
Proposed Development at
34 Alexandra Road, H' Hempstead

Nett Assets
The Studio, 141 New Road,
Croxley Green, Herts. WD3 3EN.
Tel:- 01923 293117. 07531 124528
Web:- www.nettassets.co.uk

Detail		
Site Location & Block Plan		
Date	July 2017	Job Ref 1488
Scale	1:1250, 1:200 @ A3	Dwg No. PL-00
Rev.	C	A3