

**Station Information:**

Station	Easting (m)	Northing (m)	Level (m)
GH1	506341.4690	207446.4954	138.7801
GH2	506316.6084	207451.3562	136.6696

**Legend:**

Buildings	Overhead Cable	IC	Inspection chamber	Bo	Ballard
Wall	Concrete edge	Pw	Pipe invert	IB	Illuminated bollard
Gate	Concrete edge	Gy	Gas	GB	Gas bollard
Line marking	Grass verge	Bg	Back gully	Vp	Vent pipe
Drop mark	Canopy/Overhang	Dp	Down pipe	Gr	Ground light
Concrete line	Canopy/Overhang	Pp	Pipe above ground	Lb	Letter box
Canopy	Canopy/Overhang	MH	Manhole	Ld	Ladder
Station Name	Station Name	WL	Water level	Sty	Sty
100,000	100,000	Fl	Fluorescent light	IFL	Internal floor level
Tree / Bush / Sapling	Tree / Bush / Sapling	Lp	Lamp post	THL	Threshold level
Area of Undergrowth	Area of Undergrowth	Tp	Telegraph post	Sp	Sign post
Woodland	Woodland	Ep	Electricity post	TH	Traffic light
Ridge Level	Ridge Level	Tl	Traffic light	BH	Borehole
Eaves Level	Eaves Level	Bus	Bus stop	ELC	Electric
Flat Roof Level	Flat Roof Level	Sv	Stop valve	BT	British Telecom
Gate	Gate	St	Stop tap	CBW	Control box
Iron Pallets	Iron Pallets	Er	Earth rod	TT	Tactile
Wire Mesh	Wire Mesh	Wm	Water meter	BP	Brick paved
Post & Rail	Post & Rail	WV	Gas valve	CPS	Concrete paving stones
Post & Wire	Post & Wire	Au	Air valve	CVR	Cover
Chain Link	Chain Link	ICU	Unidentified inspection	IC	Inspection chamber
Wooden Panels	Wooden Panels	Wc	Waste cut	RW	Rising wall
Concrete Panels	Concrete Panels	Rd	Roofing ridge	U/L	Unable to fix
Steel Palisade	Steel Palisade	BS	Balustrade	TCL	Tree canopy level
		CTV	Cable tv	G	Gully
		Mv	Marker post	MG	Multi gully
		Gmk	Gas marker post	Stp	Tree stump
		Ss	Softs	CL	Cover level

**OS Note:**  
Some services may have been omitted due to parked vehicles. The Ordnance Survey tile is to be used as a guide only.

**OS Buildings** **Surveyed Buildings**

This survey has been orientated to the Ordnance Survey (O.S.) National Grid (OSGB36/15) via Global Navigational Satellite Systems (GNSS) and the O.S. Active Network (OS Net).  
A true OSGB36 coordinate has been established near to the site centre via a transformation using the OSTN15GB & OSGM15GB transformation models.  
The survey has been correlated to this point and a further one or more OSGB36 (15) points established to create a true O.S. bearing for angle orientation.  
No scale factor has been applied to the survey therefore the coordinates shown are arbitrary & not true O.S. Coordinates which have a scale factor applied.  
Please refer to Survey Station Table to enable establishment of the on-site grid and datum.

Rev	Date	Description	Drawn	O. Ref.

**greenhatch group**

Topographical Surveys  Measured Building Surveys  
 Site Engineering  3D Laser Scanning  
 Utility / CCTV Surveys  Revit & BIM Models

**Rowan House**  
Duffield Road  
Little Eaton  
Derby  
DE21 5DR

Tel (01332) 830044 Fax (01332) 830055  
 admin@greenhatch-group.co.uk  
 www.greenhatch-group.co.uk

St Albans Unit B, The Courtyard Alban Park St Albans Hertfordshire AL4 0LA t. (01727) 854481	Newcastle 24 Riverside Studios Ametys Road Newcastle Bus Park Newcastle-U-Tyne NE4 7YL t. (01912) 736391	Poland ul. Panewnicka 91 40-761 Katowice Poland t. 0048 32 202 2292 www.greenhatch.pl
--	--	--

**CLIENT**  
**Synergy LLP**

**PROJECT**  
**39a Adeyfield Road,  
Hemel Hempstead  
HP2 5DR**

**TITLE**  
**Topographical  
Survey**

<b>SCALE</b> A3@ 1: 200	<b>DATE</b> 20.03.17
<b>DRAWN</b> SS	<b>QUALITY REF</b> GH0561

Level datum	See note
Grid orientation	See note
Job number	26632

Drawing No. <b>26632_T</b>	Rev. <b>0</b>
-------------------------------	------------------

**Comments**  
This plan should only be used for its original purpose. Greenhatch Group accepts no responsibility for this plan if supplied to any party other than the original client.  
All dimensions should be checked on site prior to design and construction.  
Drainage information (where applicable) has been visually inspected from the surface and therefore should be treated as approximate only.

**Notes:**

**NOTES:**

- In all cases please call the BT Dial before you dig service to mark their own pipes before any site works commences 0800 917 3303  
Always consult utility plans
1. Drainage information provided has been determined without man entry into the chambers. Whilst every effort has been made to correctly identify the depth of the chambers, it is recommended that the information should be checked in areas that are critical to the future proposed development.
  2. All sewer work and proposals to be checked by the appropriate authorities before any work commences by the use of a service or CCTV service.
  3. Only water records provided to us in other records available at time of survey or drawing issue.

**ABBREVIATIONS**

AB	Abandoned	MV	Monitoring Well
AC	Air Conditioner	NB	Noise Board
ACT	Assumed Connection Point	CH	Overhead
AG	Above Ground	OF	Offset Fill
AR	Assumed Route	OSBM	Ordinance Survey Benchmark
B	Bollard	OSA	Off Survey Area
BH	Borehole	PC	Pilot Cable
BL	Base Level	PE	Polyethylene
BTB	British Telecom Box	PR	Pipe Riser
BT	British Telecom Cover	PM	Phone Mast
CI	Cast Iron	RWP	Rain Water Pipe
CR	Cable Riser	RS	Road Sign
CTV	Cable TV	RE	Roofing Eye
CP	Catch Pit	SA	Soakaway
Co	Concrete	SP	Slance Valve
CL	Cover Level	ST	Sign Post
CWS	Combined Water Sewer	SV	Slance Valve
DI	Ductile Iron	SVP	Soil Vent Pipe
DP	Down Pipe	SVS	Soil Vapour Sample
DCC	Drivers Control Box	Tk	Tank
ER	Earth Road	TL	Traffic Light
EIC	Electricity IC	TP	Telephone Pole
EOT	End of Trace	UF	Unidentified
EP	Electricity Pole	UL	Unable to Locate
FH	Fire Hydrant	UTR	Unable to Raise
FP	Fence Post	UTS	Unable to Survey
GV	Gas Valve	UTT	Unable to Trace
GU	Guyl	VRS	Vapour Recovery
HV	High Voltage	VP	Vent Pipe
IC	Inspection Cover	WL	Water Level
INT	Interceptor	WM	Water Meter
IL	Invert Level	WV	Wash Out
LC	Lighting Column	LP	Low Pressure
LP	Lamp Post	MP	Medium Pressure
LV	Low Voltage	HVP	High Pressure
MH	Manhole Cover		

**TRACE CODES**

- TFS Trace is From Source to destination with visual evidence to confirm  
SDC Sources and/or Destinations are Corroborated  
WS Weak Signal / High interference  
VA Visual Assessment (line of site perhaps scarring)  
LA Logical Assumed source & destination exist, line added without trace  
TFR Taken From Records  
AEE Anything Else Encountered

**SITE INVESTIGATION KEY**

- BOREHOLE LOCATION  
WINDROW SAMPLE LOCATION  
TRIAL PIT LOCATION  
CBR LOCATION

**DISCLAIMER**

Whilst every effort has been taken in the preparation of this drawing, the original lines marks apparatus configuration may have been altered since the survey/drawing was produced. The user shall make further enquiries and investigations to satisfy himself as to the accuracy of the drawing and the position of the apparatus. The exact positions of the apparatus should be verified by the use of suitable detection devices and safe digging practices in accordance with HSE 647, further advice on the location of apparatus should be recommended by the owner. No representation is made by Greenhatch Group, its agents or servants as to the accuracy, completeness, and sufficiency or otherwise of this drawing and the position of the apparatus.

All apparatus shall be treated as live unless proved otherwise by the owner. It is the users responsibility to ensure that information on the location of apparatus is provided to all persons (either direct labour or contractors) working in proximity to the apparatus.

Rev	Date	Description	Drawn	Q. Ref.
-----	------	-------------	-------	---------

<input type="checkbox"/>	Topographical Surveys	<input type="checkbox"/>	Measured Building Surveys
<input type="checkbox"/>	Site Engineering	<input type="checkbox"/>	3D Laser Scanning
<input type="checkbox"/>	Utility / CCTV Surveys	<input type="checkbox"/>	Revit & BIM Models

**Greenhatch Group**

- Topographical Surveys
- Site Engineering
- Utility / CCTV Surveys
- Measured Building Surveys
- 3D Laser Scanning
- Revit & BIM Models

**Rowan House**  
Duffield Road  
Little Eaton  
Derby  
DE21 5DR

Tel (01332) 830044 Fax (01332) 830055  
a@min@greenhatch-group.co.uk  
www.greenhatch-group.co.uk

St Albans Unit B, The Courtyard Alban Park St Albans Hertfordshire AL4 6LA	Newcastle 24 Riverside Studios Armetry's Road Newcastle Bus Park Newcastle-U-Tyne NE4 7L	Poland ul. Panewnicka 91 Katowice Poland
t. (01272) 854881	t. (01912) 736391	t. 0048 32 202 2292 www.greenhatch.pl

**CLIENT**  
**Synergy LLP**

**PROJECT**  
**39a Adeyfield Road,  
Hemel Hempstead  
HP2 5DP**

**TITLE**  
**Utility  
Survey**

**SCALE**  
**A2@ 1:200**

**DATE**  
**20.03.17**

**DRAWN**  
**DH**

**QUALITY REF**  
**GH0561**

**Level datum**  
Grid orientation  
**See note**  
**See note**

**Job number**  
26632

**Drawing No.**  
26632\_T\_UG

**Rev.**  
0

**Comments**  
This plan should only be used for its original purposes. Greenhatch Group accepts no responsibility for this plan if supplied to any party other than the original client.

All dimensions should be checked on site prior to design and construction.  
Drainage information (where applicable) has been visually inspected from the surface and therefore should be treated as approximate only.

**Notes:**  
Copyright Greenhatch Group, 06/07/13

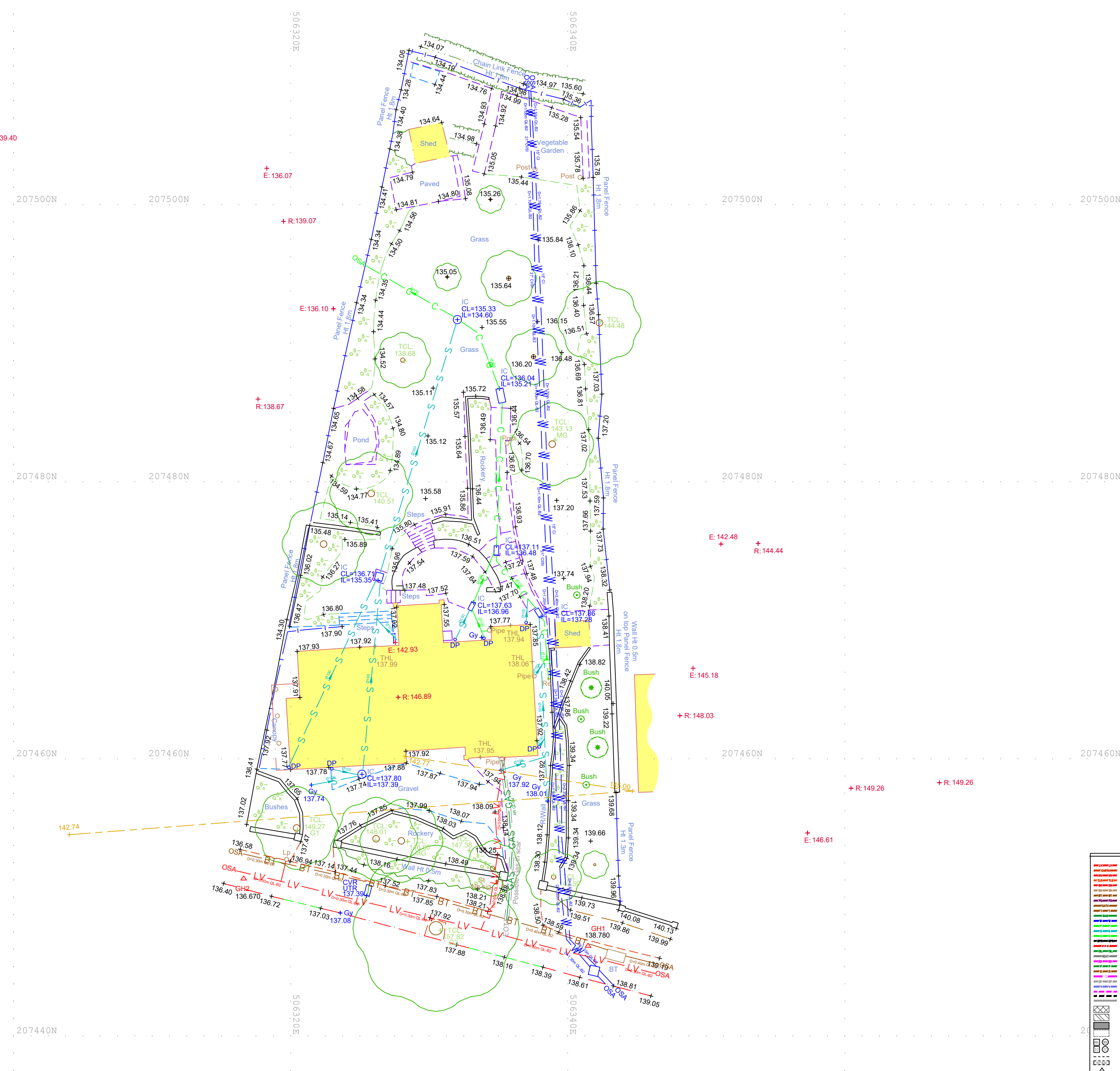

**UTILITY KEY**

	ELECTRICITY CABLE
	HIGH VOLTAGE ELECTRICITY CABLE
	TRAFFIC LIGHT ELECTRICAL CABLE
	OVERHEAD ELECTRIC LINES
	OVERHEAD TELECOM LINES
	FT CABLE
	PUBLIC OFFICE TELECOM CABLE
	WATER SUPPLY PIPE
	FOUL WATER DRAINAGE
	SURFACE WATER DRAINAGE
	COMBINED DRAINAGE
	GROUND PENETRATING RADAR
	LANDSCAPED - SEE NOTES
	HEATING MAN
	PARTY WALL
	FUEL LINE - PETROL
	FUEL LINE - DIESEL, KEROSENE OR PARAFFIN
	SEWERAGE LINE OR STORM DRAIN
	GAS PIPE
	BOUNDARY LINE
	CHAMBER EXTENTS
	CHAMBER
	MANHOLE
	INSPECTION COVER
	CHANGE OF SURFACE
	ROAD OUTLINE
	STATION LOCATION
	BOUNDARY OF PRECINCTS
	ACCESSION LOCATION

+R: 141.59  
+E: 139.40

+E: 136.07

+R: 139.07

+R: 138.67

+R: 141.97

+E: 142.48

+R: 144.44

+E: 145.18

+R: 148.03

+R: 149.26

+R: 149.26

+E: 146.61

207440N

207460N

207480N

207500N

506320E

506340E

506320E

207500N

207500N

207480N

207480N

207460N

207460N

207440N

207440N